



East Washington Centre

Located in the East Indianapolis Trade Area at the I-465 exit to East Washington Street

Features

- Anchor location available
- New Marion County Traffic Court will bring 1,000 visitors per day
- Great access and located one block from I-465 and Washington Street
- Retail shops and Office space available
- Two traffic lights make access easy
- East Washington Street is the major retail corridor on Indy's east side



2010 Demographics (estimated)

	1 Mile	3 Miles	5 Miles
Population	5,716	56,042	182,647
Households	2,376	22,878	70,918
Growth	.6%	1.6%	1.2%
Average HH Income	\$55,116	\$52,969	\$49,767
Median HH Income	\$56,864	\$52,670	\$48,528

For more information

Jake Teter
 jteter@centreproperties.net
 317.816.4646 ext 16

CENTRE
 PROPERTIES

East Washington Centre
 8100 East Washington Street, Indianapolis, Indiana

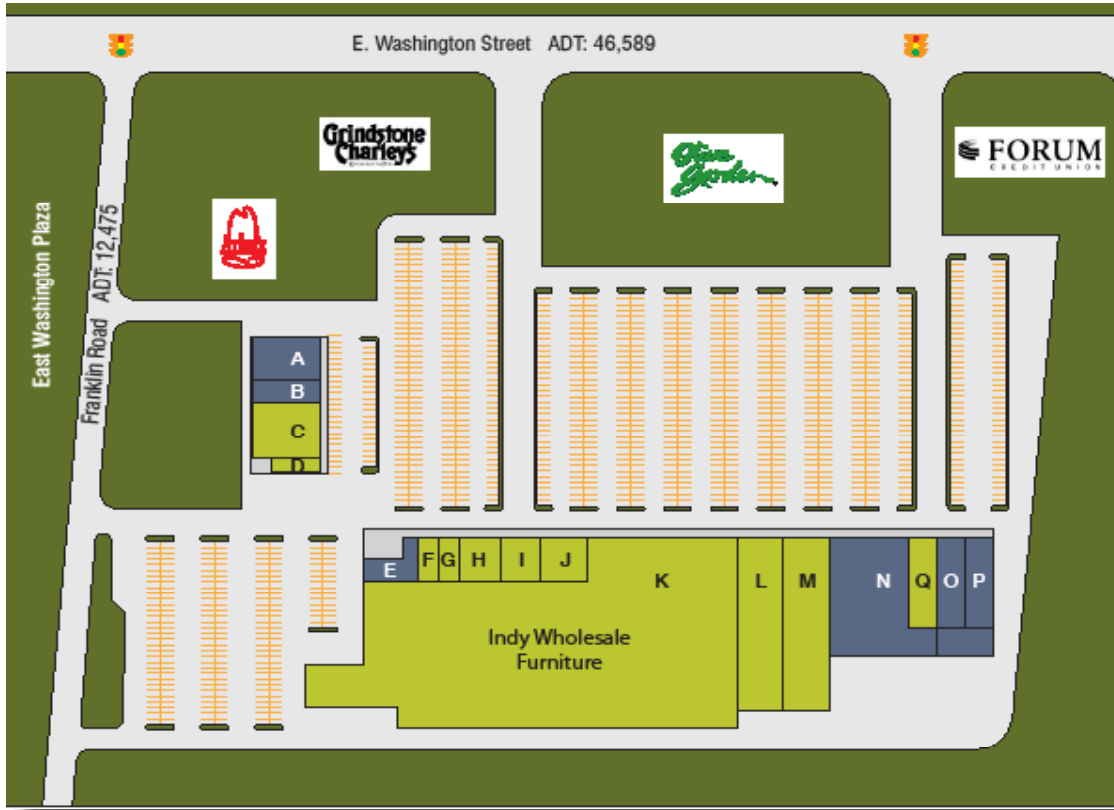

Availability

Unit	Tenant	Sq. Ft.
A	Maxim Restaurant	
B	Pyramid of Enlightenment	
C	Available	6,000
D	Available	1,200
E	Table Tennis of Indy	
F	Available	783
G	Available	745
H	Available	645
I	Available	2,700
J	Available	1,800
K	Available (Wholesale Furn)	92,825
L	Available	12,215
M	Available	12,215
N	Marion Co Traffic Court	
O	Law Office	
P	Church at the Well	
Q	Available	3,213
Total Square Feet		Approx. 166,000

TTTTT

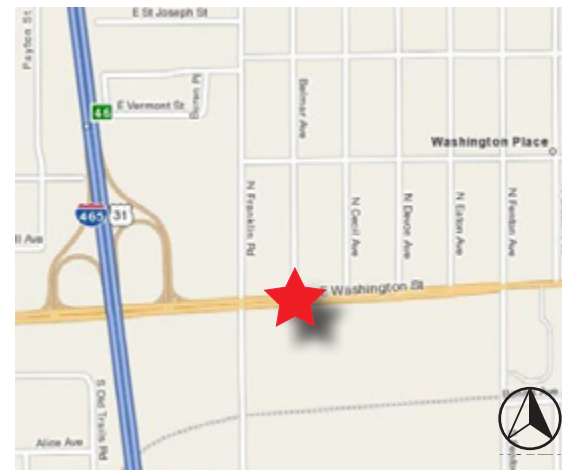

For more information

Jake Teter

jteter@centreproperties.net

317.816.4646 ext 16

CENTRE
PROPERTIES

East Washington Centre

8100 East Washington Street, Indianapolis, Indiana