



Centre North

Located in the Fishers / Northeast Indy Trade Area.

Features

- Located in Fishers, Indiana's most popular trade area.
- 2 blocks east of the Interstate-69 at 96th Street exit
- Great visibility with signalized access from 96th Street
- Retail shops and a Build to Suit opportunity available
- Walmart anchored center, which includes Staples, Petco and Pep Boys Beauty Brands, Panera Bread, Sprint, and Marsh Supermarket.
- Adjacent retailers includes Meijer, Kohl's and UA Theaters

[LINK TO PROPERTY VIDEO](#)



2010 Demographics (estimated)

	1 Mile	3 Miles	5 Miles
Population	5,043	57,359	149,133
Households	1,955	23,023	57,097
Growth	3.7%	3.9%	5.1%
Average HH Income	\$90,185	\$89,501	\$98,576
Median HH Income	\$91,210	\$89,290	\$96,027

For more information

Jake Teter

jteter@centreproperties.net

317.816.4646 ext 16

CENTRE
PROPERTIES

Centre North

8600 East 96th Street, Fishers, Indiana

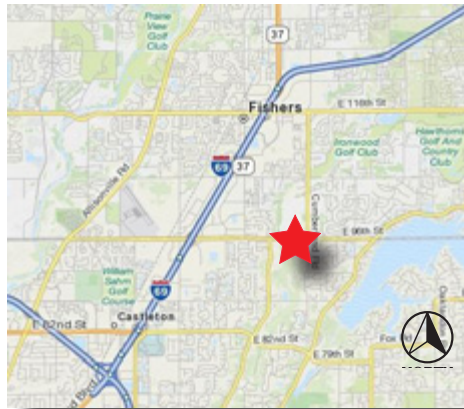

For more information

Jake Teter

jteter@centreproperties.net

317.816.4646 ext 16

Availability

Unit	Tenant	Sq. Ft.
D-1	Pep Boys	
E-1	Tuesday Morning	
B-1	Available	10,500
B-2	Available	
B-3	Petco	
H	Plato's Closet	
J	Tan & Go	
A	Panera Bread	
B	Sprint	
D	Beauty Brands	
E	Red Habanero	
F	Available	616
G	Available	3,200
A-1	Party City	
A-2	Available	1,800
C-1	Nail Salon	
C-2	King Chef	
C-4	Leslie's Poolmart	
C-5	Einstein Bros. Bagels	
C-6	Noodles	
	Available Storage	1,500
Total Square Feet		Approx. 130,000

CENTRE
PROPERTIES

Centre North

8600 East 96th Street, Fishers, Indiana